

ROTECH / RMR 2

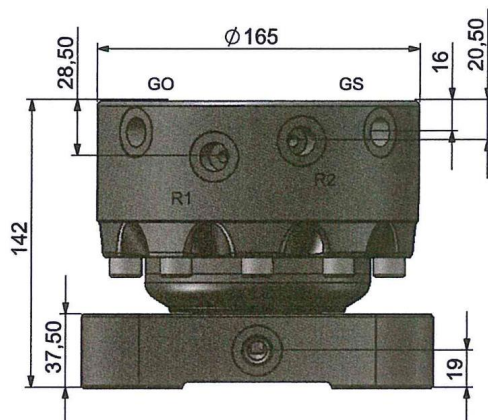

Caractéristiques :

- Haute pression
- Rotation continue
- Positionnement optimisé
- Design ultra compact

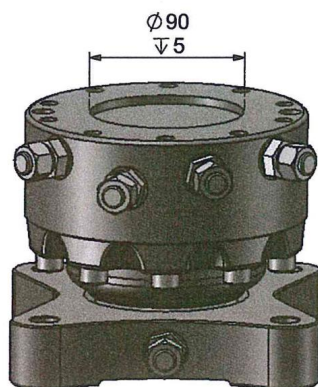
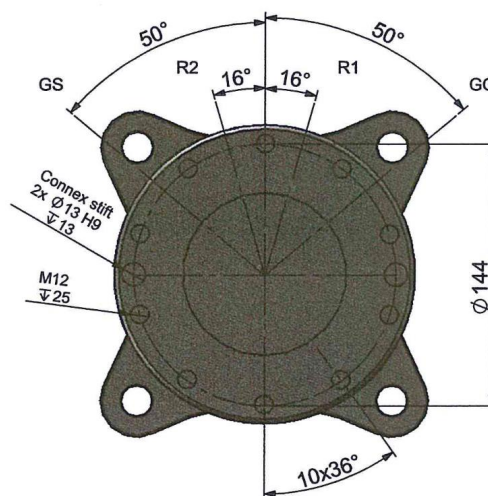
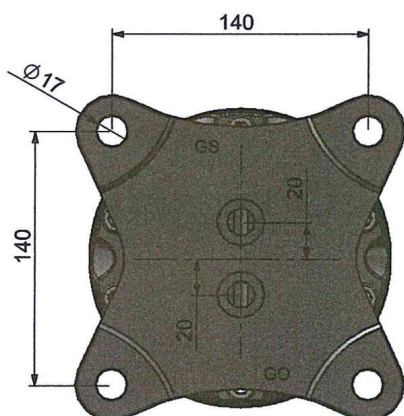

CARACTERISTIQUES



RMR 2

15

3

320

18

360°

1100

3/8"

6

2



ENTREPRISE VINCENT TRAVAUX PUBLICS
3082, ROUTE DEPARTEMENTALE 113
13340 ROGNAC

Tél : 04.42.46.07.62 Fax : 04.42.46.07.98

Mail : vtp@vincent-tp.fr
www.vincent-tp.fr